



BOWER WAY SLOUGH, SL1 5HD

We are delighted to present an exceptional opportunity for buy-to-let investors to acquire this impressive top floor apartment, located in the highly sought-after area of Cippenham.

Situated within walking distance of local supermarkets and Cippenham schools, this property offers convenience and accessibility. With a short drive or bus

£260,000



2



1



2

EPC C

GROUND FLOOR
702 sq.ft. (65.2 sq.m.) approx.

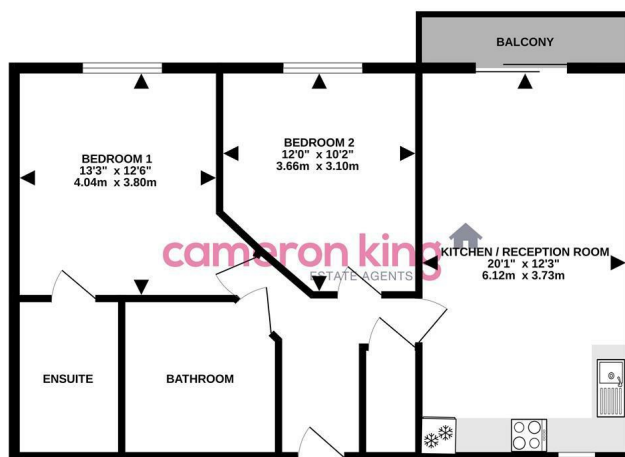

TOTAL FLOOR AREA - 702 sq ft. (65.2 sq m.) approx.
While every attempt has been made to ensure the accuracy of the floorplan contained herein, measurements of floors, walls, doors and any other items are approximate and no responsibility is taken for any error, omission or misstatement. This plan is for illustrative purposes only and should be used as such by any prospective purchaser. The fixtures, fittings and appliances shown here are not intended to be taken as a guarantee as to their condition or efficiency and are for information only.

journey to Slough and Maidenhead Town Centres (approximately 5-10 minutes), as well as easy access to the M4 Motorway, Junction 7, commuting and travel become effortless. Heathrow Airport, Central London, and the M25/M40 Motorway Network are all within easy reach.

For commuters, Burnham station is just a 10-minute walk away, while Slough station is a 10-minute drive. Both stations provide regular train services to London Paddington (every 10 minutes), with a journey time of approximately 15 minutes. Furthermore, both stations are set to benefit from the upcoming Crossrail project, making this investment even more promising.

Internally, the property boasts a generously sized living area with open access to a well equipped kitchen, two double bedrooms (one with an en-suite), a family bathroom suite, access to 'Juliette' balcony and spacious communal gardens. Additionally, allocated parking is available.

For further information or to arrange a viewing, please do not hesitate to contact us.

- Sold with no Onward Chain
- 0.4 miles from Burnham Rail Station (Main Paddington and Elizabeth Line Station - 20 minutes to Central London)
- Within walking distance of Cippenham School & Burnham Grammar
- East access to M4 Motorway (Junction 7)
- Access to residents off street parking
- Close to local shops
- Excellent transport links
- EPC Rating C



411 Bath Road, Slough, SL1 5QL
t: 01628 667442
e: sales@cameronking.co.uk

